

GEONFINO



Smart Lock
Model No. G5 Pro
Installation instructions



FINGERPRINT



PASSWORD



APP



RFID CARD



BLUETOOTH

Please keep and read these instructions before installation, we also prepared an instructions video to help you on our Amazon Page. If you need further assistance, please contact Customer Service by email: geonfino@afterservice.vip

Table of Contents

- < 1 > Installation Video
- < 2 > Installation Guide
- < 11 > How to Use
- < 12 > Programming Instructions
- < 13 > APP Guide
- < 22 > Auto Re-lock Mode
- < 23 > Gateway management
- < 24 > Low Power/Emergent Power
- < 24 > Factory Default Settings
- < 25 > Restore Factory Settings
- < 25 > Troubleshooting
- < 26 > FCC Warning
- < 27 > About GEONFINO and
Customer Service

Installation Video



Please scan the QR code to watch installation video for the smart lock before you install it.



1. How to Confirm the direction of the door



2. How to add a RFID card



3. How to restore Factory Settings



4. How to add Fingerprint

Installation Guide

What is inside

A. Latch

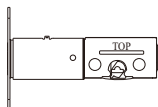

B. Keypad



C. Battery Cover

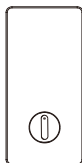

D. Interior Assembly

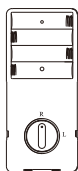

E. Mounting Plate

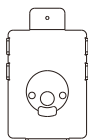

F. Strike/Strike Box

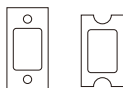

G. Waterproof Rubber Pad

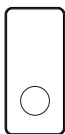

H. Interior Assembly Screws



I/J. Mounting Plate Screws

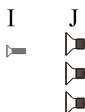

K. Latch / Strike Screws



L. RFID Card



M. Keys

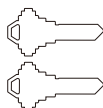

1 Prepare the door and check dimensions

- A** Measure to confirm that the backset is either 2-3/8" or 2-3/4" (60 or 70 mm).

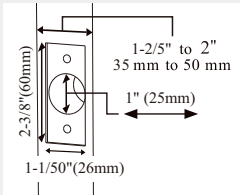
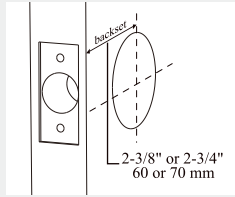

- B** Measure to confirm that the hole in the door edge is 1" (25mm). And measure to confirm that the door is 1-3/5" to 2" (35mm to 50mm) thick. Measure the size of the square slot is 2-3/8" x 1-1/50" (60x26mm).

2 Install the latch and strike

- A** Hold the latch in front of the door hole, with the latch face flush against the door edge.

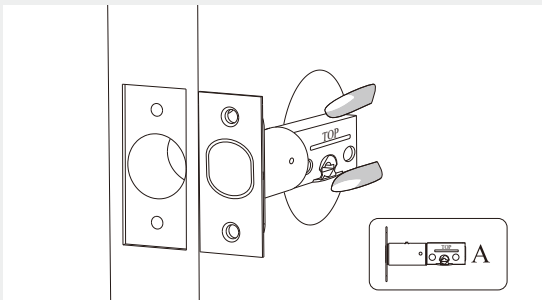

Is the slotted hole centered in the door hole?

YES

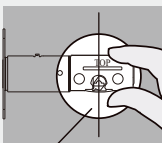

Slotted hole is centered.



No adjustment is required. Proceed to next step.

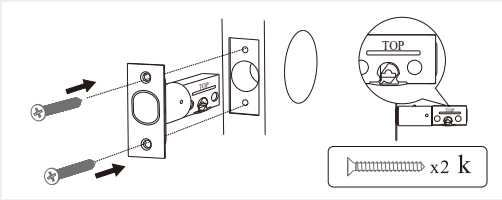

NO

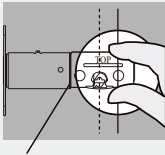

Rotate and pull the latch as shown to extend latch.

Slotted hole is not centered.

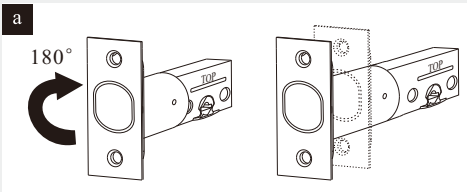

Rotate the head of latch 180°

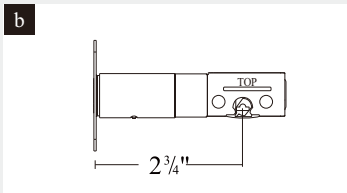

B

Use a screwdriver to test if deadbolt works smoothly. When the screwdriver turns, the deadbolt would be lock/unlock.

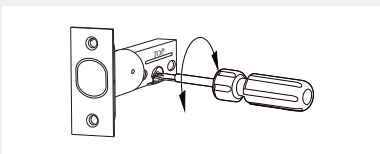

C Install strike on the door frame.

⚠ IMPORTANT: Make sure hole in door frame is drilled a minimum of 1" (25 mm) deep.

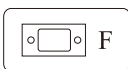
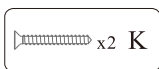
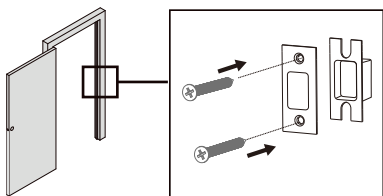

3 Installation instructions

A **⚠ IMPORTANT:** Before installation, make sure the latch is fully retracted (in the unlocked position).

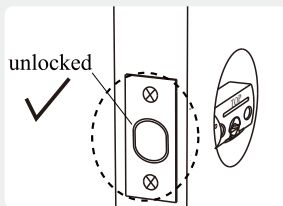
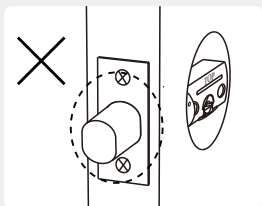

B Install Keypad

If the hole is bigger than 2 1/8" (54mm), install the keypad directly

YES

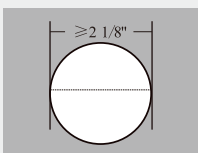

No adjustment is required. Proceed to next step.

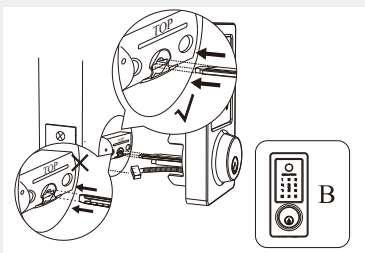

Please ensure the tail bar is Horizontal ⚠ during installation. The wired IC needs to be under the deadbolt.

NO

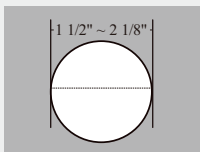

Remove the hole cover

a

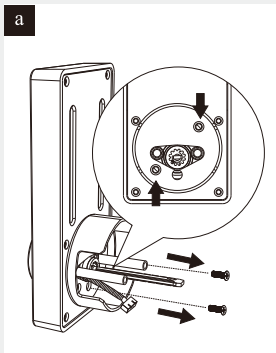

Remove screw from hole cover

b

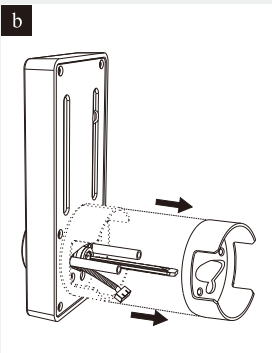

Remove the hole cover

c

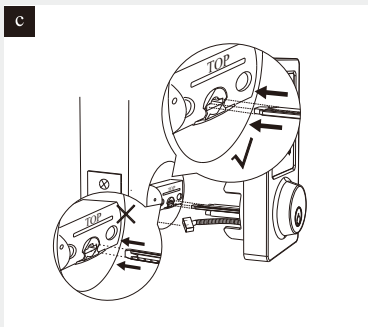

Please ensure the tail bar is Horizontal ⚠ during installation. The wired IC needs to be under the deadbolt.

C Install Mounting Plate

a

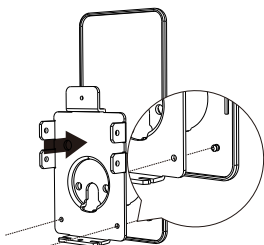

Put the mounting plate on the waterproof rubber pad

b

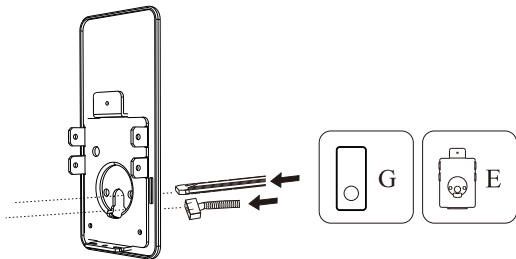

The wired IC and tail bar go through the hole of mounting plate

c

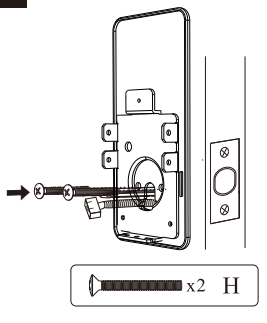

Secure the mounting plate with the supplied screws.

d

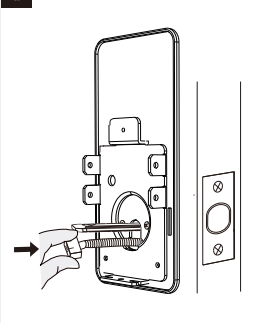

Make sure the wired IC is not too long.

D Confirm the direction of the door

⚠ Look at the door from the OUTSIDE

Left Hand Door

Right Hand Door

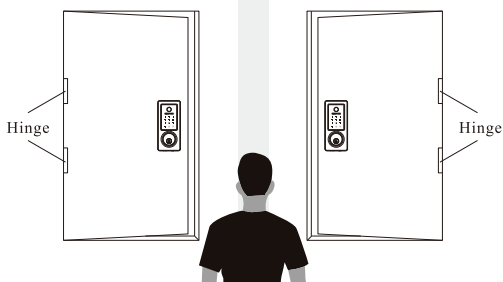

Adjust the Toggle Switch (in the bottom right corner of the back panel) and Turn Piece.

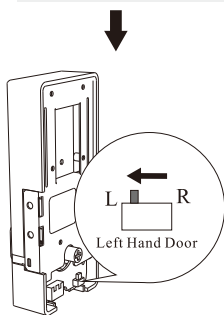

Flip to L for Left-handle

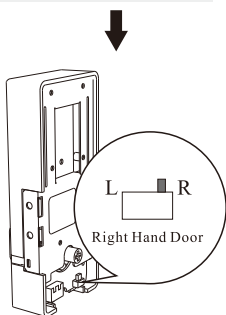

Flip to R for Right-handle

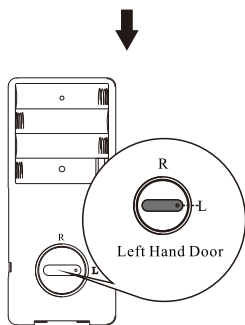

Horizontal for Left-handle

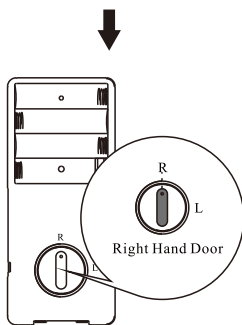

Vertical for Right-handle

E Install Interior Assembly

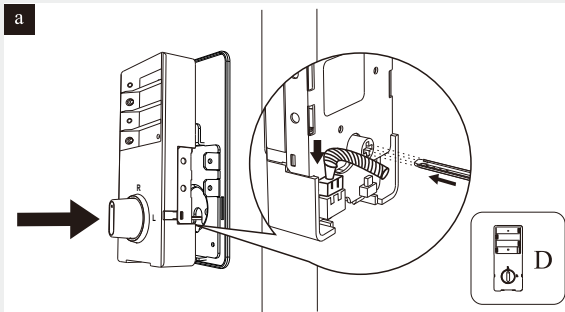

Connect the cable and ensure it's a tight connection, and that the tail bar is inserted in the turnpiece hole.

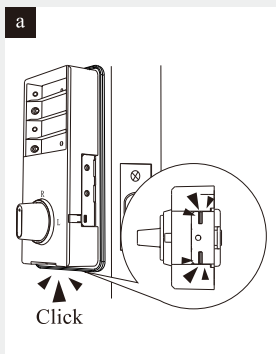

Install the interior assembly on mounting plate and make sure they click on together.

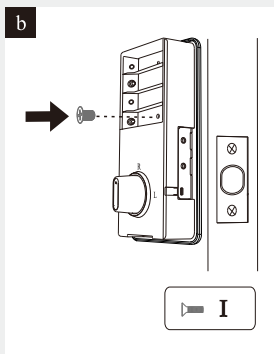

Secure the interior assembly with the supplied screws.

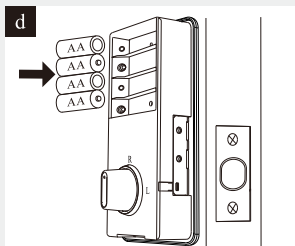

Load 4 AA batteries into the interior assembly.

⚠ IMPORTANT: For best results, use new, non-rechargeable Alkaline batteries only.

F Install Battery Cover

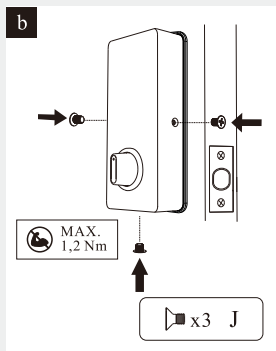
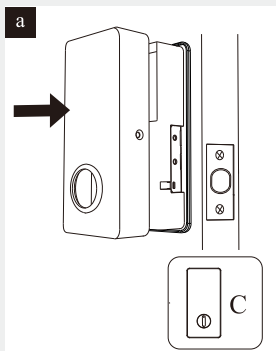

How to Use

LOCK the door from outside

Manual Mode

Press "✓" key on keypad for 3 seconds.



LOCK the door from inside

Manual Mode

Rotate the thumb turn to Lock position.



UNLOCK the door from outside

RFID Card



Key

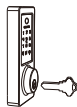

RFID Card needs to be added first

Master/
User
code



FingerPrint



UNLOCK the door
from inside

Rotate the thumb turn to
Unlock position.

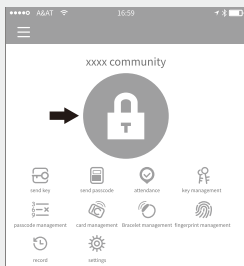

Via APP

Long press "🔒" to LOCK the door from outside or inside. Click "🔓" to UNLOCK the door from outside or inside.

Note: Please keep your phone near the door lock within 32.8ft (10m).

Programming Instructions

Information & Safety Warnings

- Protect your User Codes and Master Code.
- Protect your key. It is suggested to put it outside the door, such as your car.
- Restrict access to your lock's interior assembly and routinely check your settings to ensure they have not been altered without your knowledge.
- This lockset is designed to provide the highest standard of product quality and performance. Care should be taken to ensure a long-lasting finish. When cleaning is required use a soft, damp cloth. Using lacquer thinner, caustic soaps, abrasive cleaners or polishes could damage the coating and result in tarnishing.

⚠ IMPORTANT: Do not load batteries until lock is completely installed.

Definitions

Master Code

Required for programming and feature settings. The master code can be used to unlock the door under vacation mode. The default master code needs to be changed before programming. Property owner/manager should keep this information confidential.

1. Master Code (6 to 8) digits: The default Master Code is 123456. It is required that you change it to a code of your own before programming.
2. User Code (6 to 8) digits: A total of 200 User Codes may be programmed.

Auto Lock

Automatically locks the deadbolt after unlocking. This feature is off by default. You can set the auto lock time in the app.

Wrong Entry Limit

After 5 unsuccessful attempts at entering a valid PIN code, the unit will shut down for 5 minutes.

Unlock with Fake Code

User can prevent PIN code exposure from strangers by entering random digits before or after PIN code.

83618 137192 14710

 password
----- Random digits -----

APP Guide

A Download APP "TTLock "



Android Mobile Phone--Please search "TTLock" from Google Play.
Apple Mobile Phone--Please search "TTLock" from App Store.

B Register a new account (phone number or email)

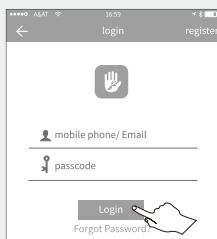
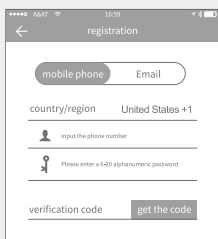
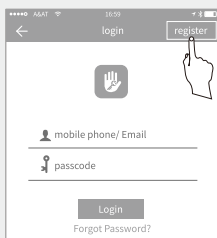

C Lock adding

- a Turn on Bluetooth and enter the interface of adding lock in app.

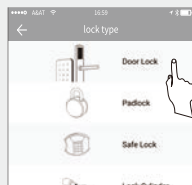
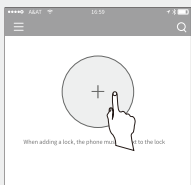
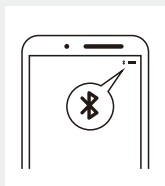

b Light up the screen and add the lock

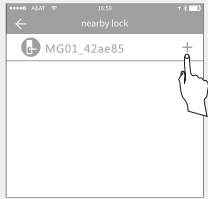
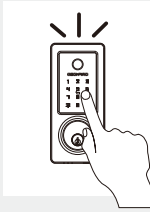
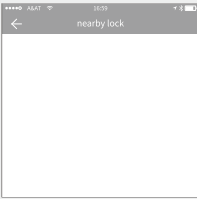

Note: Please keep your phone near the door lock within **10 meters**.
After adding the lock, the initial password: 123456 will become invalid.

D Key management

After the administrator successfully adds the lock, owner owns the highest administrative rights to the lock. owner can send keys to others. Meanwhile owner can increase the key management that is about to expire.

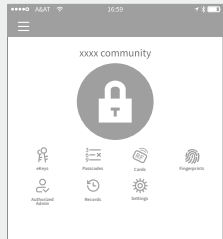

Click the type of lock it will show the time-limited ekey, one-time ekey and permanent ekey.

Time-limited ekey: The ekey is valid for the specified time.

Permanent ekey: The ekey can be used permanently.

One-time ekey: The ekey will be automatically deleted once it has been used.

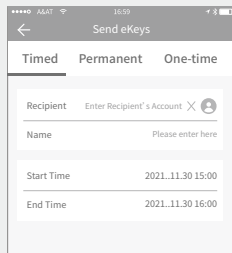
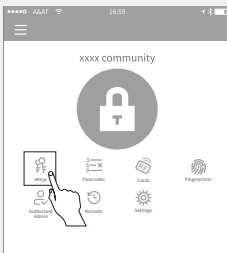

The manager can delete ekey, reset ekey, send and adjust the ekey, meanwhile he can search the lock record.

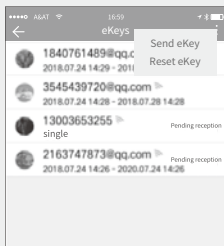
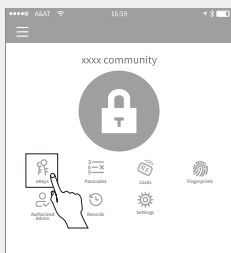

E Passcode management

After inputting the passcode on the keyboard of the lock, press the unlock button to unlock. Passcodes are classified into permanent, time-limited, one-time, empty, oop, custom, etc.

The password that has been set can only be unlocked, but cannot be locked.

a Permanent passcode

The permanent passcode must be used within 24 hours after it is generated, otherwise it will automatically expire.

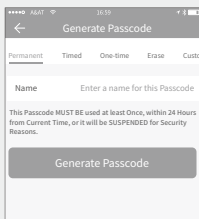
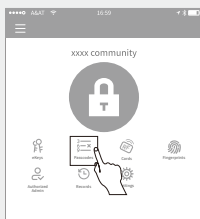

b Time-limited passcode

The time-limited passcode can own an expiration date, which is a minimum of one hour and a maximum of three years. If the validity period is within one year, the time can be accurate to the hour; if the validity period is more than one year, the accuracy is to the month; when the time-limited passcode is valid, it should be used within 24 hours, otherwise it will automatically expire.

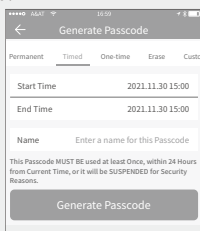

c One-time passcode

One-time passcode can only be used for one time, and which is available for 6 hours. It will automatically expire.

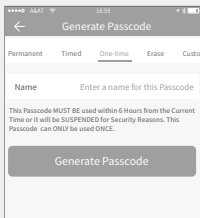

d Erase passcode

Erase Passcode is VALID for 24 Hours from the Current Time. Caution -All Passcodes used on this Lock will be DELETED on using this Passcode.

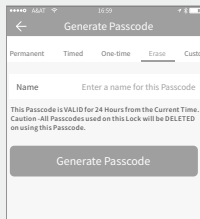

e Custom passcode

You can Configure your own Passcode. It needs to be between 6- 9 Digits in Length. You can Configure the Customized Passcode via Bluetooth or Remotely via a Gateway.

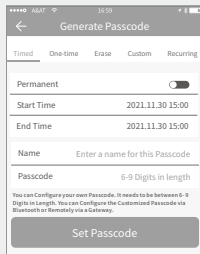

f Recurring passcode

The Recurring password can be reused within a specified time period, including daily type, weekday type, weekend type, and more.

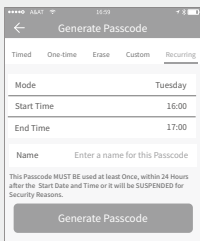

g Passcode sharing

The system added new communication options like whatsapp to help users share the passcode.

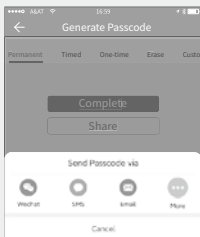

h Passcode management

All generated passcodes can be viewed and managed in the password management module. This includes the right of changing the password, deleting the password, resetting the password, and unlocking the password.

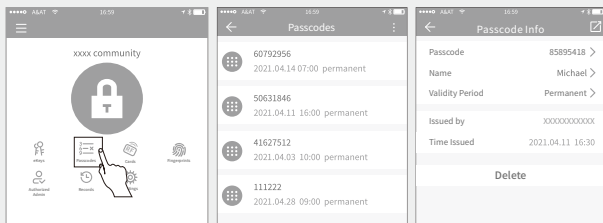

F Card management

You need to add the RFID card first. The whole process needs to be done via the app beside the lock. The validity period of the IC card can be set, either permanent or time-limited.

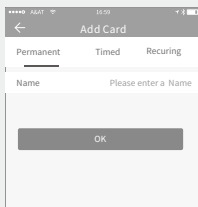

All RFID cards can be queried and managed through the RFID card management module. The remote card issuance function is displayed in the case of a gateway. If there is no gateway, the item is hidden.

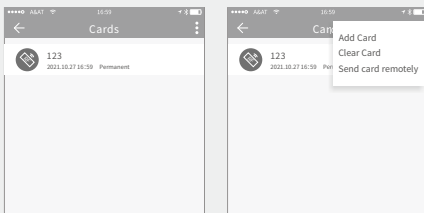

a Add a RFID card

Click "Cards", then click "Add card"

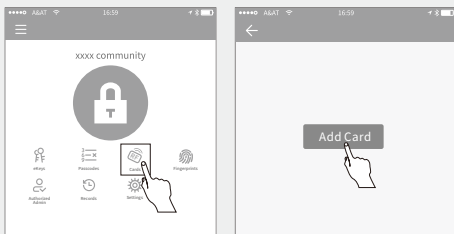

There are three options for you. Select "permanent", "timed" or "recycling" as needed. Enter the name of the RFID card, and click "OK". Then the RFID card can be successfully added when it is close to the card sensing area of the lock for 2-3 seconds.

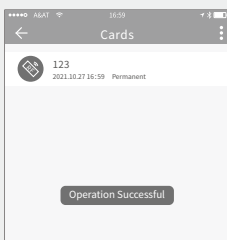
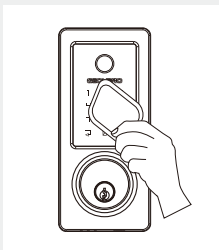
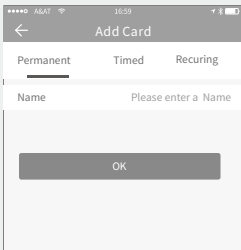

To add an RFID card again, click on the upper right corner of the "Cards" homepage, click "Add Card". Then repeat the operation of adding RFID card.

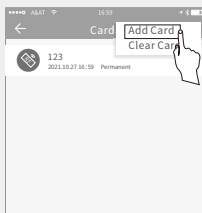
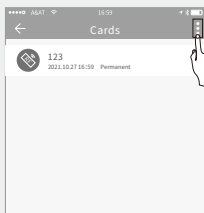

b Delete RFID cards

Click on the upper right corner of the "Cards" homepage and click "Clear Card" to delete all RFID cards.

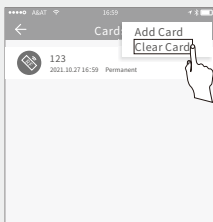
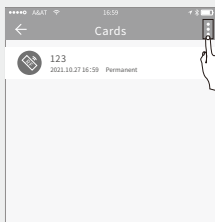

We can also choose a single RFID card to delete.

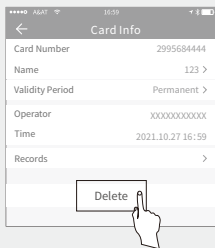
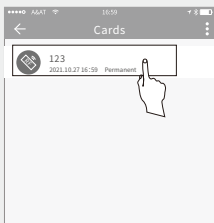

G Fingerprint management

Fingerprint management is similar to IC card management. After adding a fingerprint, you can use the fingerprint to unlock the door.

a Add Fingerprint

Click "Fingerprint", then click "Add Fingerprint".

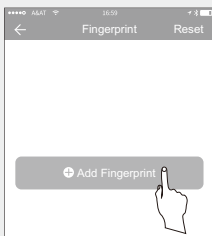
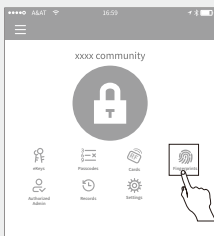

There are three options for you. Select "permanent", "timed" or "recycling" as needed. Enter the name of the Fingerprint, and click "OK". Then click "Start" and you will be required to Place and Remove your Finger from the Sensor 4 Times.

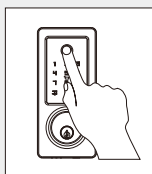
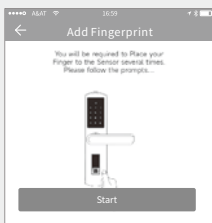
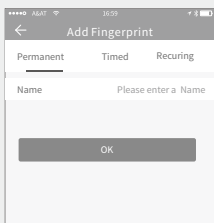

b Delete Fingerprint

Click the fingerprint you want to delete, then click "Delete".

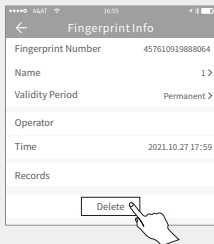
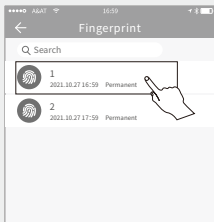

G Records

It records who comes and goes, and when for 24/7 access logs, get all records about the door unlock/lock anytime and anywhere.

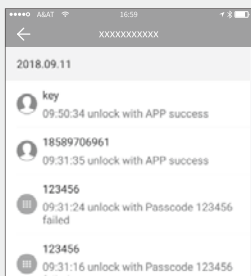
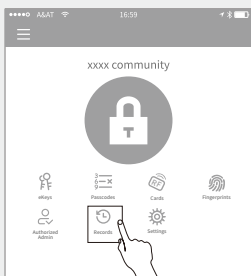

H Setting

In the system settings, it includes touch unlock switch, group management, gateway management, security settings, reminder, transfer smart lock and so on.

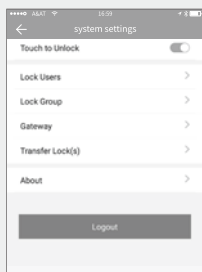

a User management

The user name and phone number can be seen in the user list. Click the customer you want to view to get the door lock information.

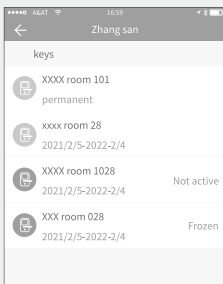
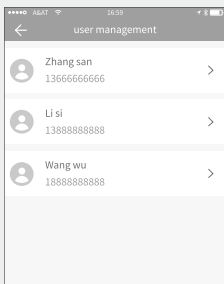

b Key groups management

In the case of a large number of keys, you can use the group management module.

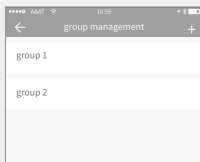

c Transfer admin rights

The administrator can transfer the lock to other users or to the apartment (Room Master user). Only the account that manages the lock has the right to transfer the lock.

After inputting the account, you will receive a verification code. Filling in the correct number, you will transfer successfully.

The account of the apartment transfer receiver must be the administrator account.

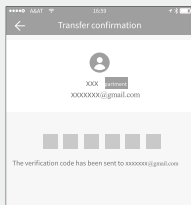
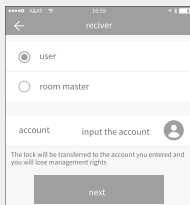
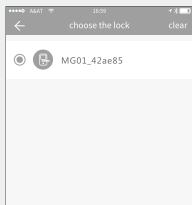

d Lock recycling station

If the lock is damaged and cannot be deleted, the lock can be deleted by moving it into the recycling station.

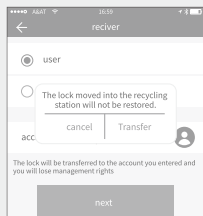

Auto Re-lock Mode

Auto Re-lock Mode can be set up in APP. (5s, 10s, 15s, 30s, 60s, Custom). When the lock be unlocked via APP, passcode or RFID card, it will re-lock automatically in the reset time,

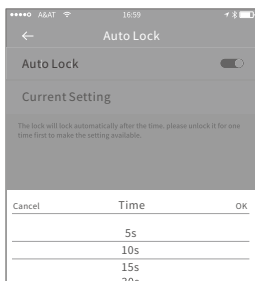
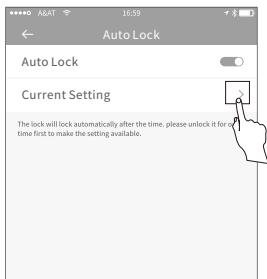
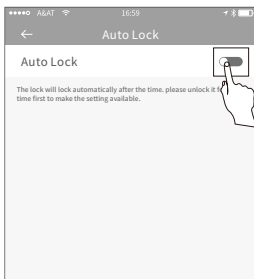
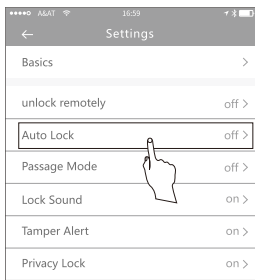
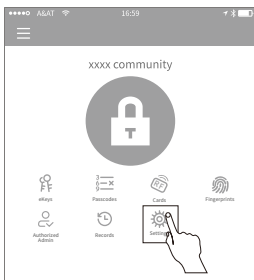

Gateway management

(Gateway needs to be purchased separately)

The Smart lock is directly connected via Bluetooth, that is why it is not attacked by the network. The gateway is a bridge between smart locks and home WIFI networks. Through the gateway, the user can remotely view and calibrate the lock clock, read the unlock record. Meanwhile, it can remotely delete and modify the password.



Gateways are added via an app before they can be used. Here are the steps:

- (1) Open the TTLOCK APP;
- (2) Touch the "☰" icon on the top left of the screen;
- (3) Select [Gateway];
- (4) Select the "G2";
- (5) Plug in the Gateway and power it on;
- (6) While the light is flashing alternately in red and blue, press "+" sign;
- (7) Add Gateway;
- (8) Select the network and input your WiFi password

⚠ Notice: If the above process times out, please power off and try again.

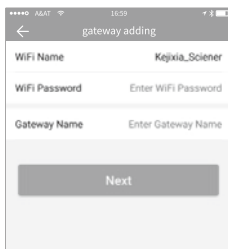
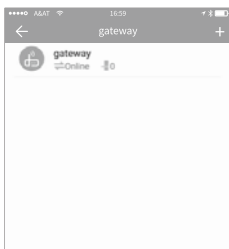

Low Power

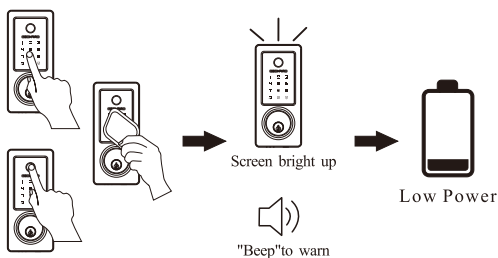

When the smart lock is opening, the screen will brighten up and “beep” to warn that the battery is low power.

Emergency Power

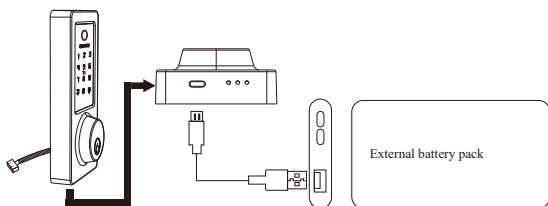

If the lock is low power and unable to operate, there is a Micro USB power socket at the bottom of lock for power supply.

Factory Default Settings

Settings	Factory Default
Master Code	123456
Auto Lock	Disabled
Silent Mode	Disabled
Wrong Code Entry Limit	5 times
Shutdown Time	5 mins

Restore Factory Settings

Restore on APP

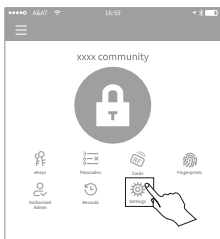

Select
“Settings”
in the APP

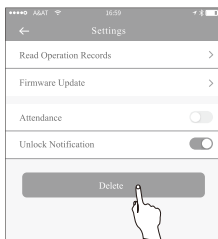

Select “Delete”
and insert user
login password

Restore on lock

1. Press and hold the Reset button.
2. Keep holding the Reset button for 6 seconds, until you hear the sound of beep.

Note: This operation need the wired IC and battery to be installed. This button is behind the Interior assembly.

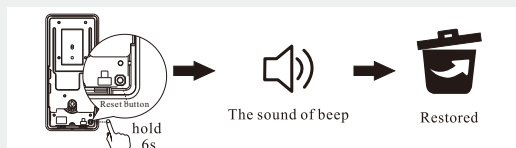

Troubleshooting

The turnpiece cannot rotate or operate the lock.

Remove and re-install the lock, making sure that the turnpiece is in right position.

The lock cannot be locked or unlocked by the keypad.

Make sure that the codes are not disabled. If needed, restore the lock's default settings.

The keypad doesn't respond when touched (no lights are visible and no beeping is heard) .

Make sure the cables are properly connected, and make sure the batteries are new and installed correctly.

I forgot my Master Codes.

Perform a reset in order to erase all passcodes. Once the reset is complete, all passcodes will be erased and the Master code will return to the default value (123456).

The lock cannot connect APP via bluetooth

Please make sure the bluetooth is on. The APP is ready to search the lock. If needed, restore the lock's default setting.

Multiple attempts unlock the door also failed to open

Use the key to open the lock and change the battery. If needed, please contact customer service.

FCC Warning

This device complies with part 15 of the FCC Rules. Operation is subject to the following two conditions: (1) this device may not cause harmful interference, and(2) this device must accept any interference received, including interference that may cause undesired operation. Any changes or modifications not expressly approved by the party responsible for compliance could void the user's authority to operate the equipment.

NOTE: This equipment has been tested and found to comply with the limits for a Class B digital device, pursuant to Part 15 of the FCC Rules. These limits are designed to provide reasonable protection against harmful interference in a residential installation. This equipment generates, uses and can radiate radio frequency energy and, if not installed and used in accordance with the instructions, may cause harmful interference to radio communications.

However, there is no guarantee that interference will not occur in a particular installation. If this equipment does cause harmful interference to radio or television reception, which can be determined by turning the equipment off and on, the user is encouraged to try to correct the interference by one or more of the following measures:

--Reorient or relocate the receiving antenna.

– Increase the separation between the equipment and receiver.

– Connect the equipment into an outlet on a circuit different from that to which the receiver is connected.--Consult the dealer or an experienced radio/TV technician for help. To maintain compliance with FCC's RF Exposure guidelines, This equipment should be installed and operated with minimum distance between 20cm the radiator your body: Use only the supplied antenna.

GEONFINO

Dear customer,

Greetings!

Thank you very much for your purchase! We are so honored to have you as our customer, and we have great confidence to provide you with premium products and friendly service.

About GEONFINO

As an innovative and high technology corporation, GEONFINO is dedicated to R&D, designing, producing and marketing of Smart lock products. Our top-guns in the Smart lock field have constantly developed a series of products with features like fashion, human care, energy efficiency, and environment protection. And we highly value concepts of "People Oriented, Practical and Innovative." A professional seller in the smart lock field will always be a nice company to your life!

Warranty

GEONFINO not only provides a 1-year warranty for all our products but also offers high-level after-sales service. Please kindly contact us immediately and we will supply a replacement or refund if you encounter any of the following:

1. Receiving defective items;
2. Short packaging;
3. Parts are broken in transit;
4. Item stops working within warranty;
5. Wrong order.

Importance

Valuable Customers, if you like our products and service, please share your wonderful experience with us and other customers, we will be very grateful. If you're dissatisfied with what you get, before writing negative feedback, please contact us, we will try our best to solve the issue to your satisfaction. Thanks for your vote of confidence again! We wish you a very happy life!

Best regards!

**Customer Service E-mail: geonfino@afterservice.vip
TEL: +1 833 637 2188**

Scan here to contact us
[24Hrs Online]



<https://geonfino.afterservice.vip>

